

Caution!

Do not attempt to plug the 12V adapter into the power socket of your modem.

Do not incinerate or dispose of in fire.

Do not disassemble or mistreat.

Do not expose to temperatures greater than 60°C.

Warranty

Unwired offers a warranty against faulty manufacture. Refer to unwired.com.au for the full terms and conditions of the warranty.

Specifications

Capacity: 16 Watt-Hours

Input Rating: 12.0 VDC, 3.0A

Output Rating: 6.0 VDC, 3.4A

Operating Temperature: 5°C to 40°C

Storage Temperature: 0°C to 35°C

Dimensions: 47 x 45 x 85 mm HxWxD

Mass: Approximately 235g



External Battery Quick Start Guide



Charging your external battery for the first time

Before you use your external battery for the first time, it must be charged for approximately **four** hours. After the initial charge, you will need to recharge the battery for **three** hours to obtain a full charge.

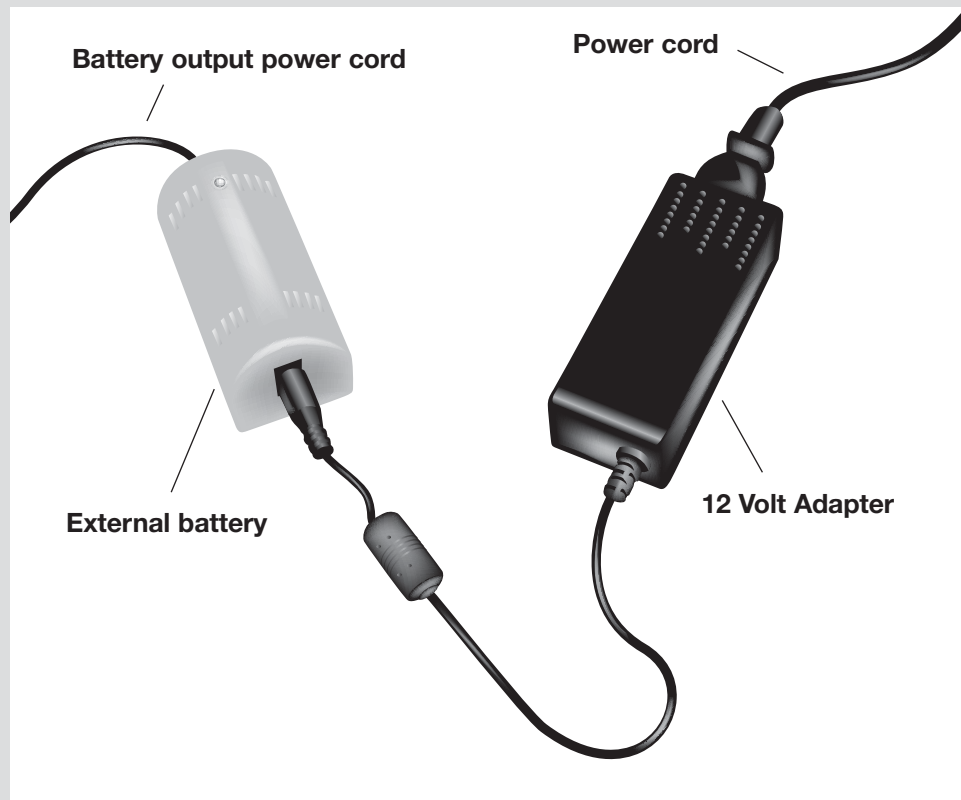

Once you have unpacked your battery, please follow the 3 steps outlined below:

1. Plug the provided power cord into the 12 Volt adapter.
2. Attach the 12 Volt adapter to the back of your external battery.
3. Plug the power cord into a power point and charge the battery for four hours.

Note: The initial charge should be completed before connecting the battery to your Wireless Modem.

Warning: Do not attempt to connect the battery power supply directly to your Wireless Modem.

Using your external battery

The external battery is compatible with all Unwired Wireless Modems. It allows you to take your modem anywhere within our coverage area without the need for a power point.

To connect the battery to your modem simply connect the battery output power cord into the Wireless Modem.

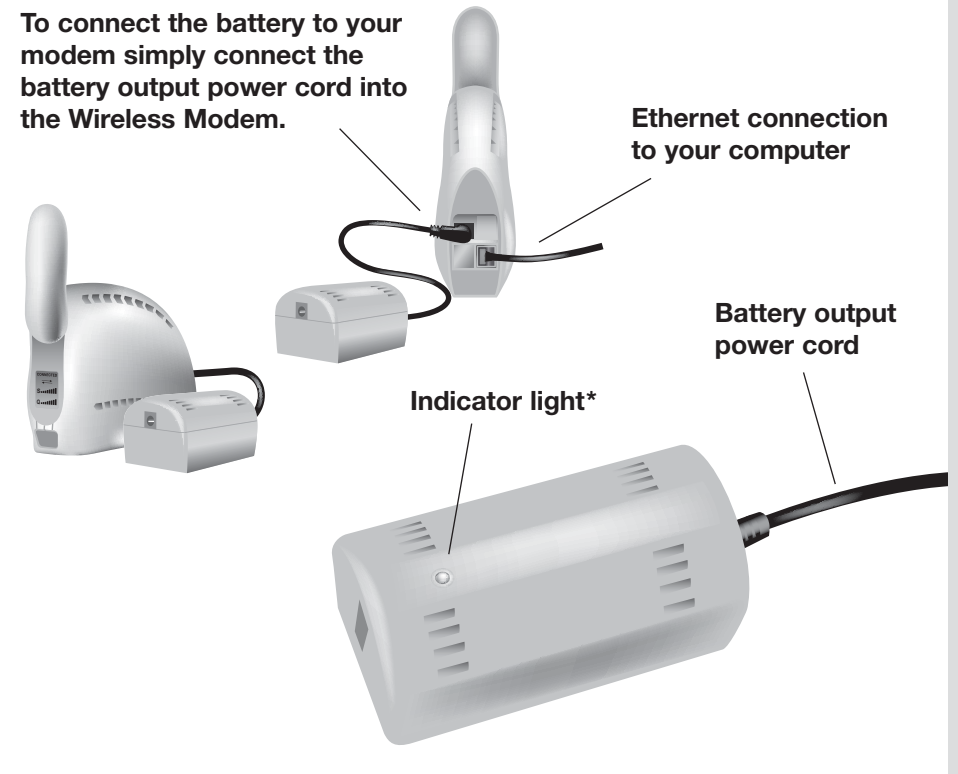

Battery Performance

The performance of the battery will depend on how the Unwired Wireless Modem is being used. After the initial charge, the battery will need to be recharged for three hours to obtain a full charge.

Performance table

Usage	Battery Life
Standby	Up to 2.5 hours
Moderate	Approx. 1.2 hours
Heavy	Up to 1 hour

* The indicator light will display amber while the battery is being charged. Once fully charged the indicator light will display green. Once the charger is disconnected from the power point the indicator light will remain off until the battery is running low on power. A red light display signifies that the battery has approximately 5 minutes of power remaining and will require a recharge.

Note: After the initial charge the battery will not need to be disconnected from the Wireless Modem whilst recharging.